

How to Set Up Restrictions on your child's iPad

Part 2

Turning off the News Feed

An important feature to consider turning off on your child's iPad in Restrictions is the **News** feed.

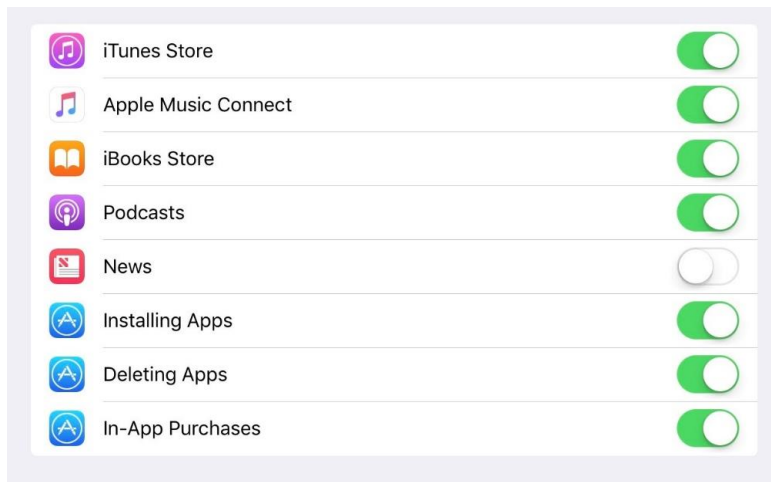

If you have **News** switched on, when your child swipes to the right on their iPad, they will see a **News** feed of current top stories.

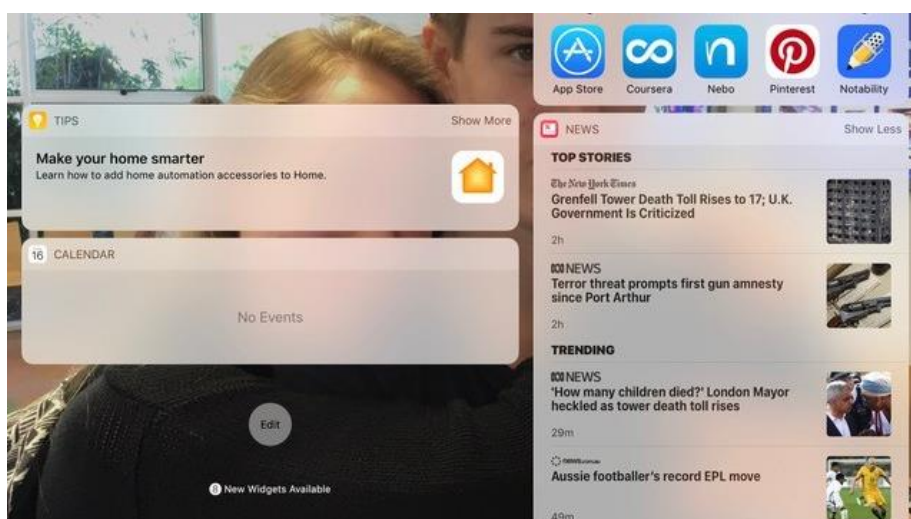

If you tap on a **News** story you are taken to a new screen with details about the **News** story. These stories may be distressing for children as they contain images of current events and may contain links to more stories, which again may be inappropriate for young children.

Turning off Location Services

Location services uses GPS, Bluetooth Wi-Fi to determine your location. Location Services allows applications and websites to gather and use information based on the current location of your computer. You have to give your permission before an app or website can use your location data. Turning off Location services for **Safari** in Restrictions prevents it from being switched back on.

It may useful to use location services when accessing **Maps**. Location services are used for some games such as **Pokemon**, which you may allow your child to play. Apart from these examples there are not many other good reasons to allow location services on your child's iPad.

When location services are switched on for the **Camera**, the location where a photo was taken is attached to the photo, potentially creating a safety concern if your child is sharing photos on the internet or through Apps. You can switch off Location services for particular **Apps** such as **Safari** or turn it off altogether and then select **Don't Allow Changes** to prevent Location services from being switched back on.

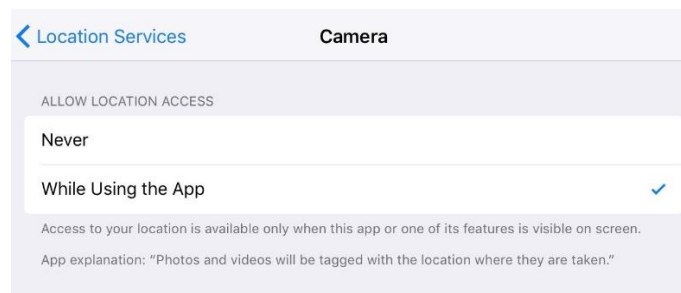
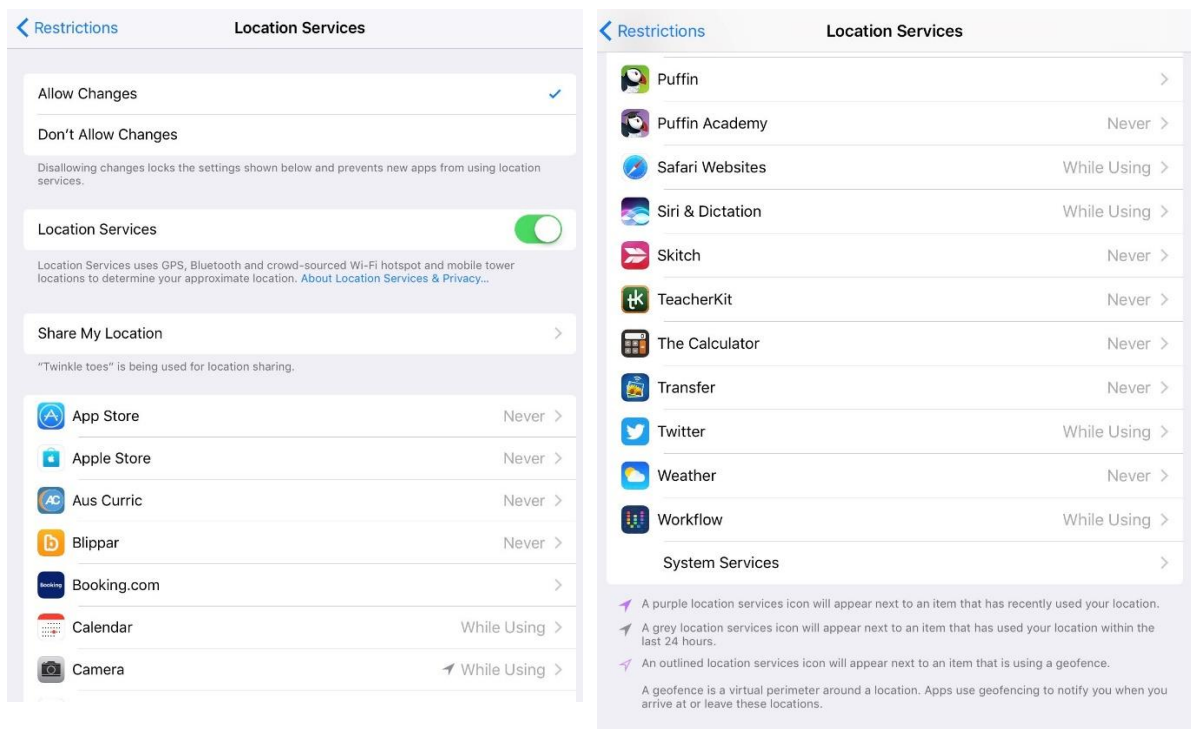

Setting Accounts Restrictions

You can turn off **iCloud account** features such as iMessage, Facetime and Mail in settings and in Restrictions. By selecting **Don't Allow Changes** your child cannot make any changes to iCloud accounts on the iPad such as adding, removing or modifying accounts in Mail, Contacts and Calendars. This feature also prevents iMessage, Facetime and Mail from being switched back on in Settings.

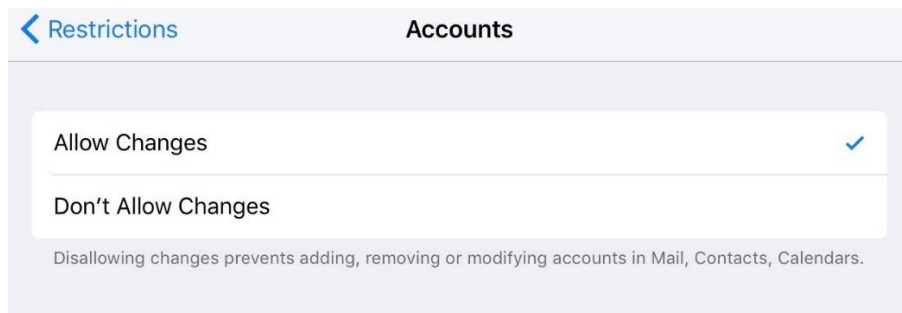

Setting Restrictions on Game Centre

Apple's **Game Centre** is included on iPhone, iPad, and Mac. It's a social gaming service for games on Apple's platforms. With **Game Centre**, you might see friend invites, game invites, and other notifications. This is a feature you can switch off in Restrictions so that your child can't interact with other people through Game Apps.

